

Assembly Instructions

Desk With Drawer

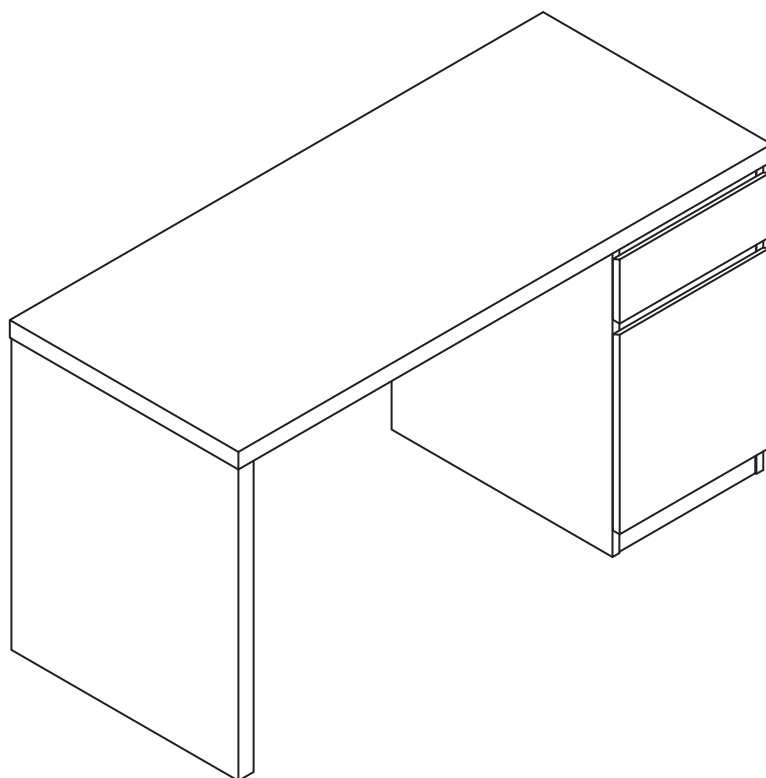

E1 test result: Passed

marketB

STOP!

Before you start...

1

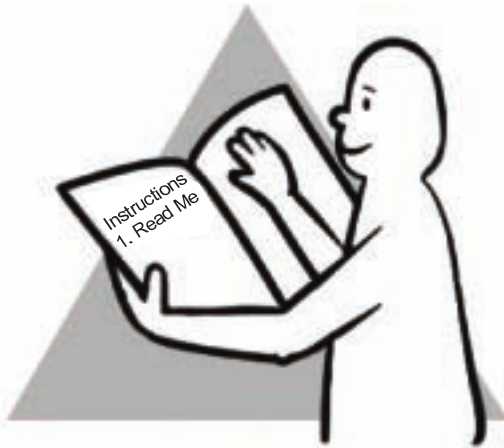

Read instructions carefully.

2

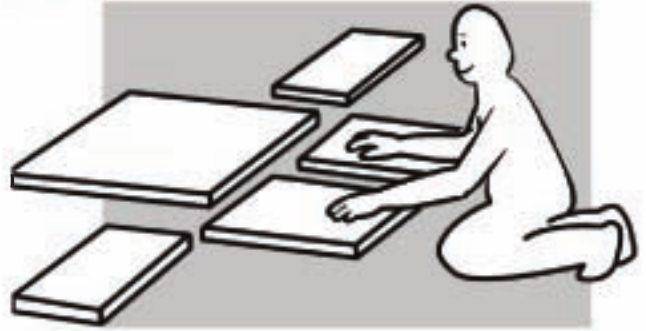

Lay out all of the components on a soft surface as if you were preparing to do a jigsaw puzzle.

3

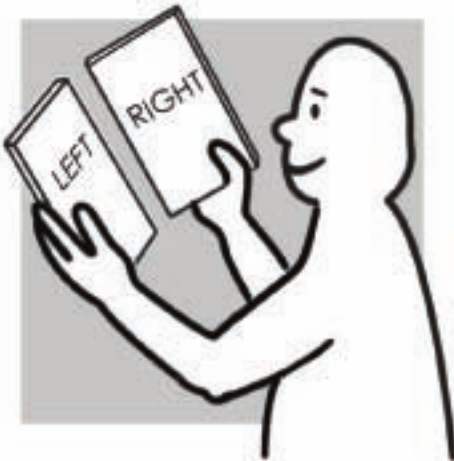

Carefully identify each component, especially those that are similar. The most common mistake is getting things back to front.

4



Separate and identify each component from the hardware pack and rest each one in its proper location before fastening.

5



Do not over-tighten screws.

6



Do not set glue until you are certain that the parts belong together.

TO ADJUST YOUR DOORS TO MAKE THE GAPS MORE EVEN (OPTIONAL).

STEP 1

Open the door.

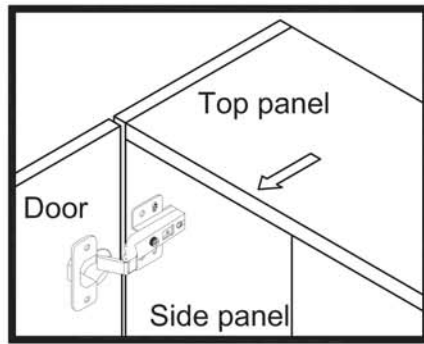

STEP 2

Adjust the gap between door panel and side panel

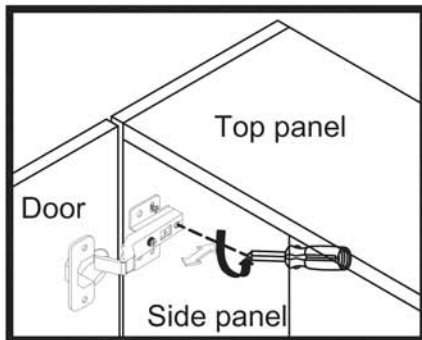

Loosen the screw indicated a little, adjust the hinge to right position (see step 2a & 2b), then tighten the screw.

STEP 2a MOVE DOOR IN

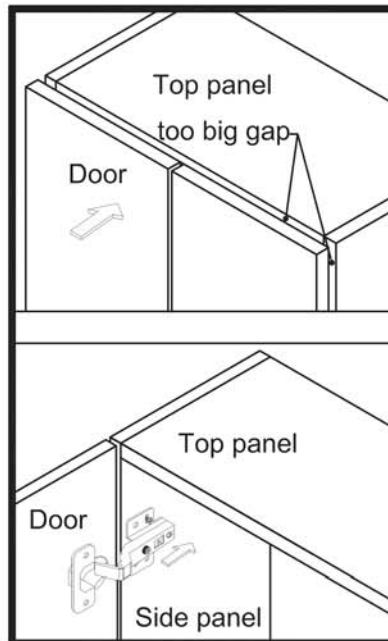

Push the hinge back a little.

STEP 2b MOVE DOOR OUT

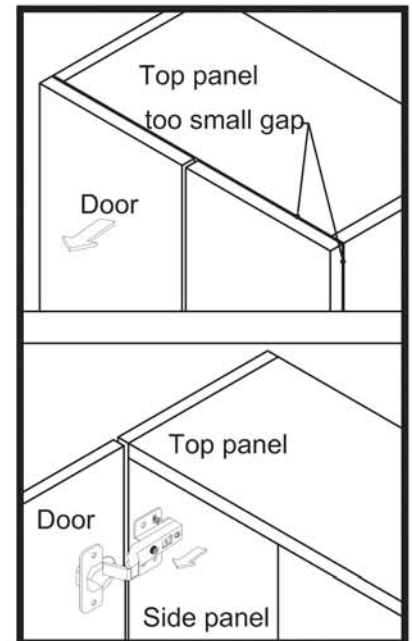

Pull the hinge forward a little.

STEP 3

To adjust the gap between two door

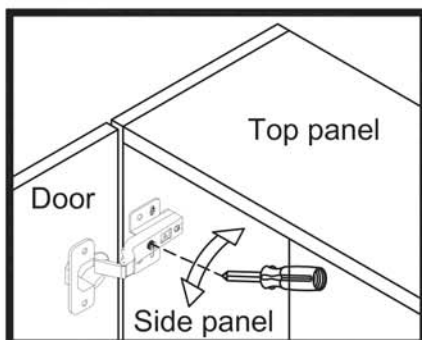

Loosen or tighten the screw indicated a little to adjust the gap between doors panels (see step 3a & step 3b)

STEP 3a MOVE DOOR RIGHT

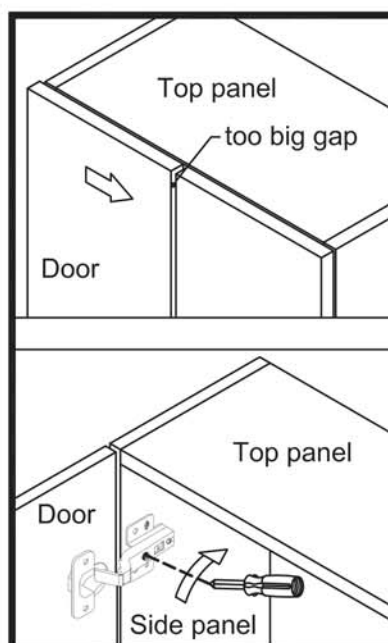

Turn the screw clockwise a little as shown to make the gap small.

STEP 3b MOVE DOOR LEFT

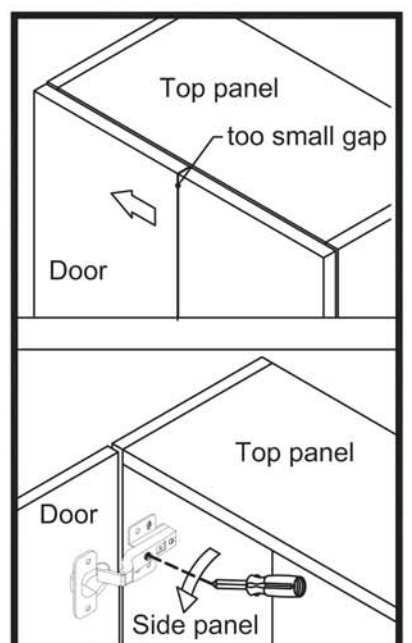

Turn the screw counterclockwise a little as shown to make the gap big.

HERE'S HOW

Desk With Drawer

05.26.2017 Issue 1

SOME STEPS MAY REQUIRE
TWO PEOPLE.

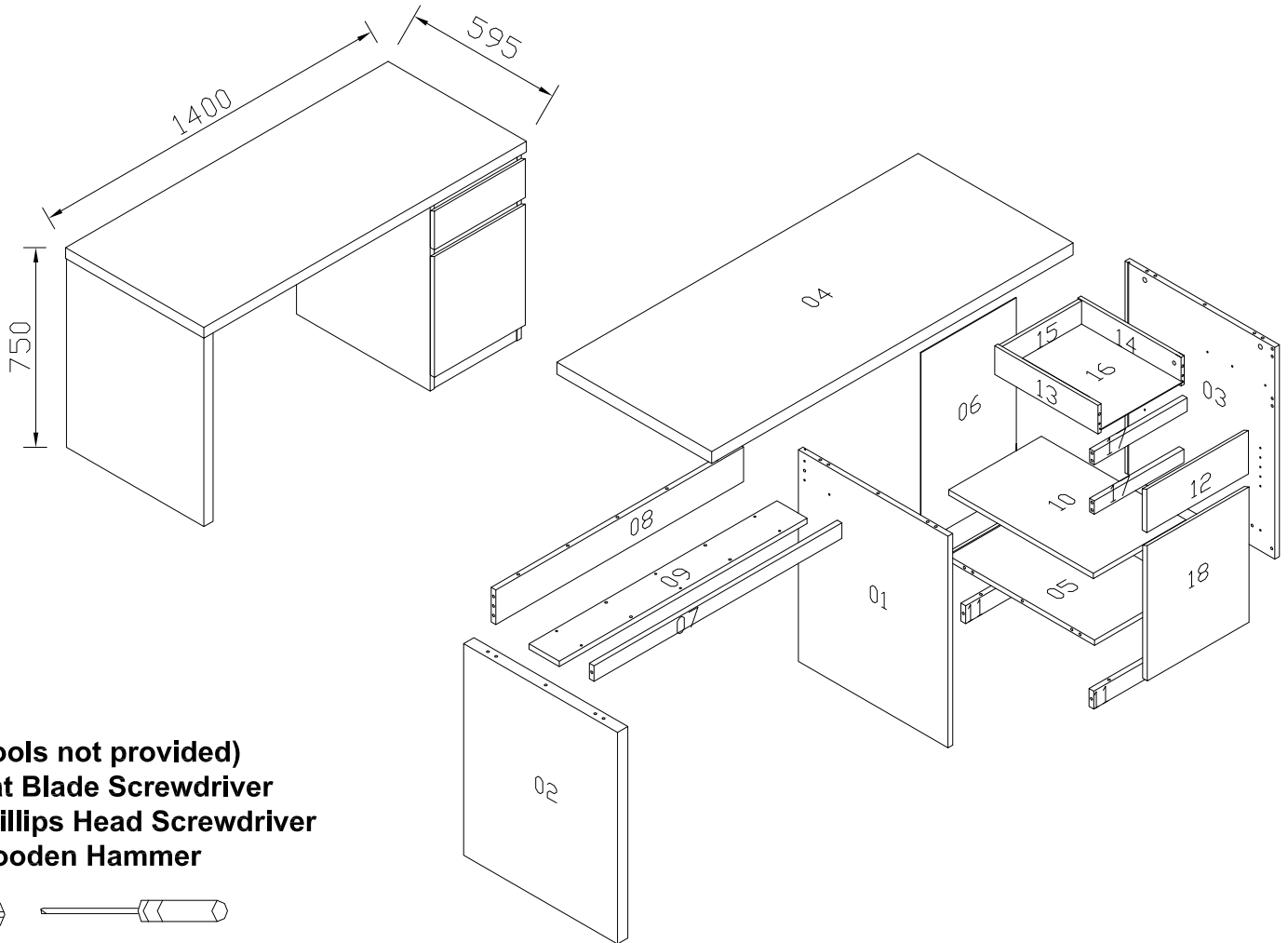
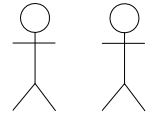

(Tools not provided)
Flat Blade Screwdriver
Phillips Head Screwdriver
Wooden Hammer

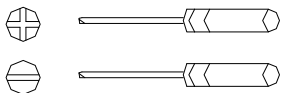

CHECK YOUR COMPONENTS



To Assemble the Body

Wooden Hammer

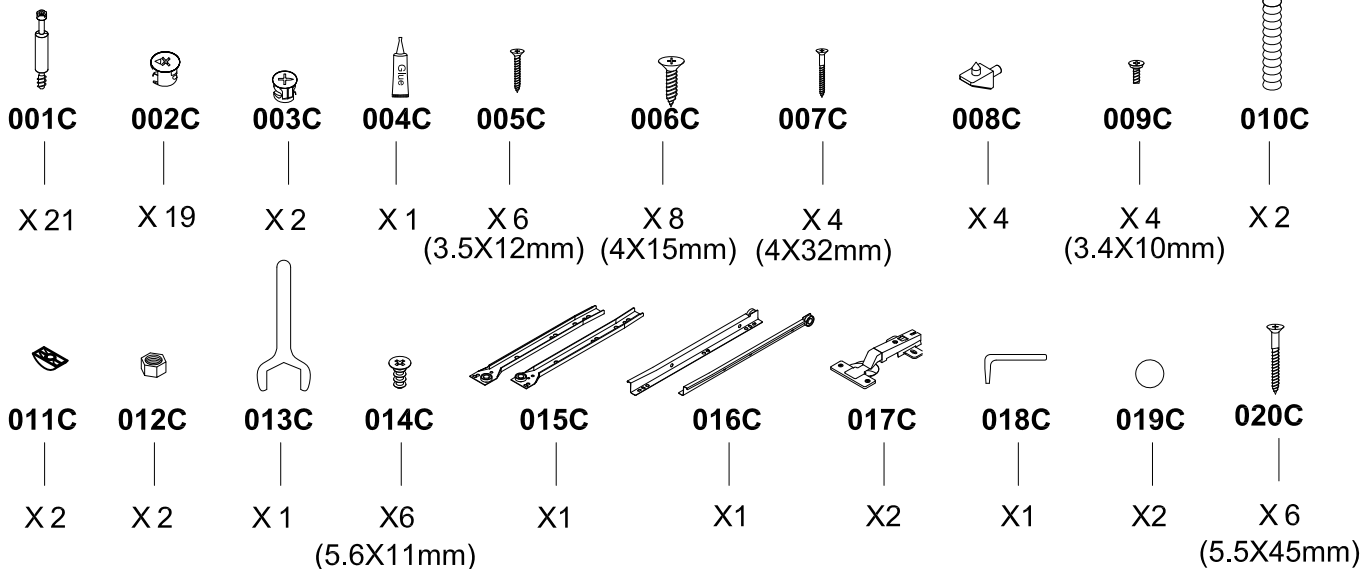

STEP 1

Will require these parts:



015C
X1



001
X6



014C
X6



014C
X6

015C
X1

192 128

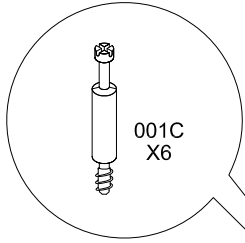

001C
X6

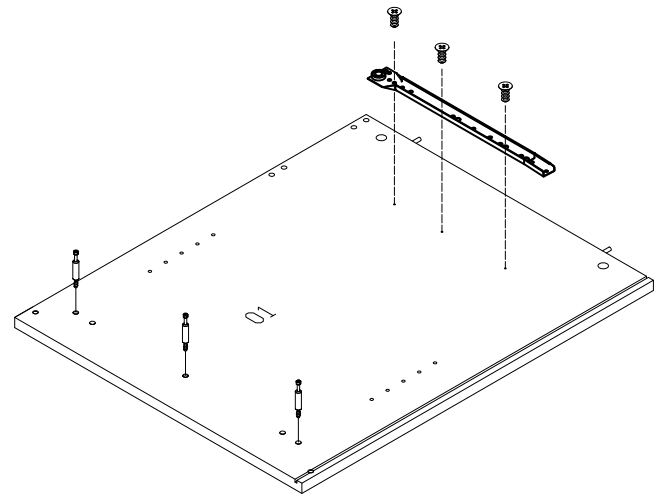
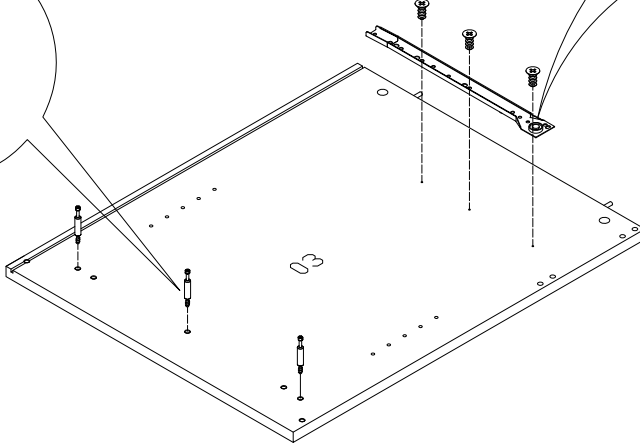

STEP 2

Will require these parts:



007C
X4

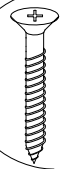

007C
X4

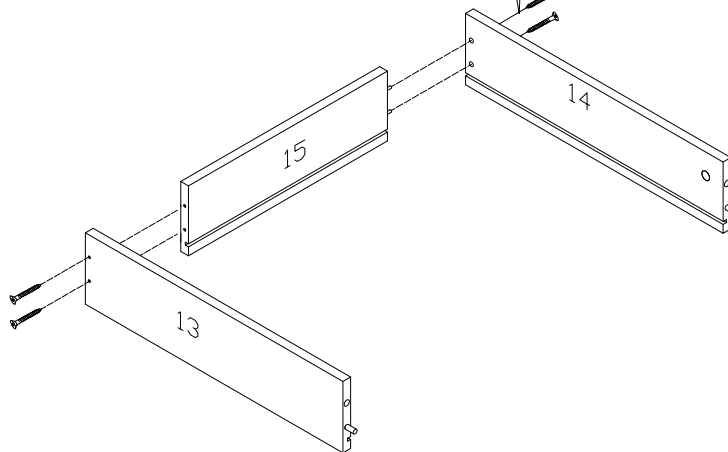

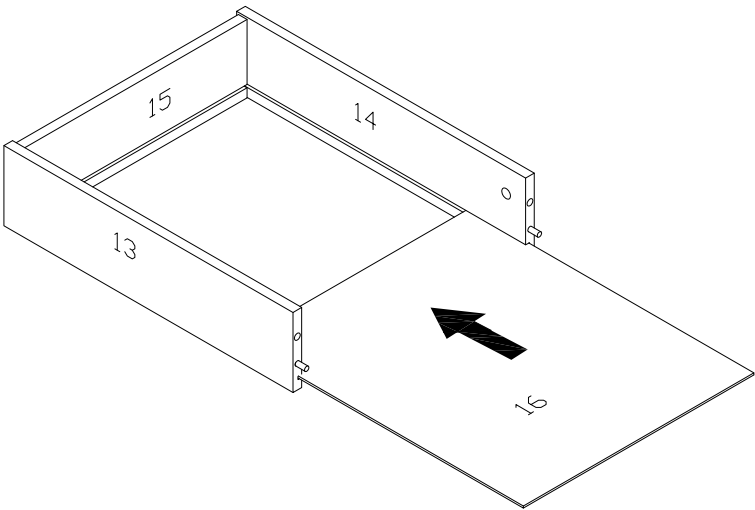

STEP 4

Will require these parts:



003C

X 2



001C

X 2



004C



004C



003C

X 2

Arrow to point
in the direction
of the hole

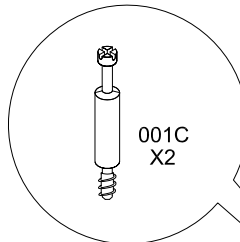

001C
X2

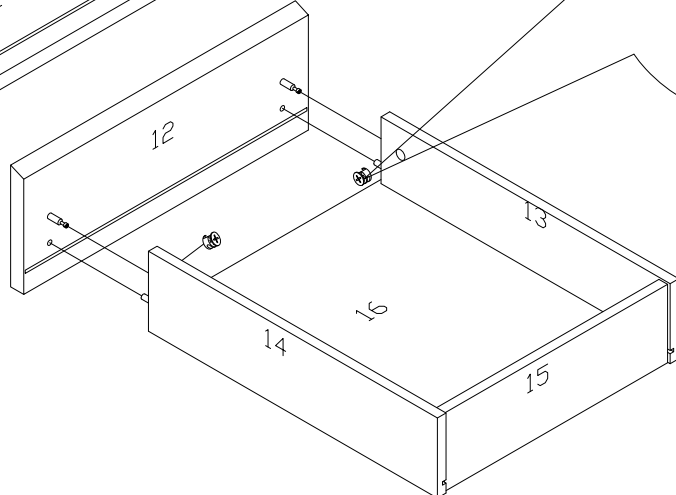
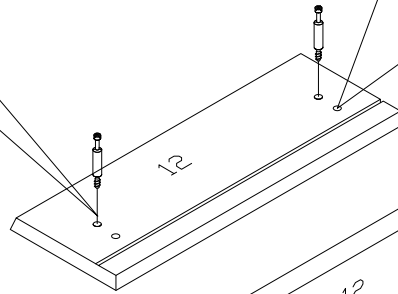

STEP 5

Will require these parts:

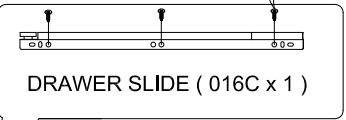
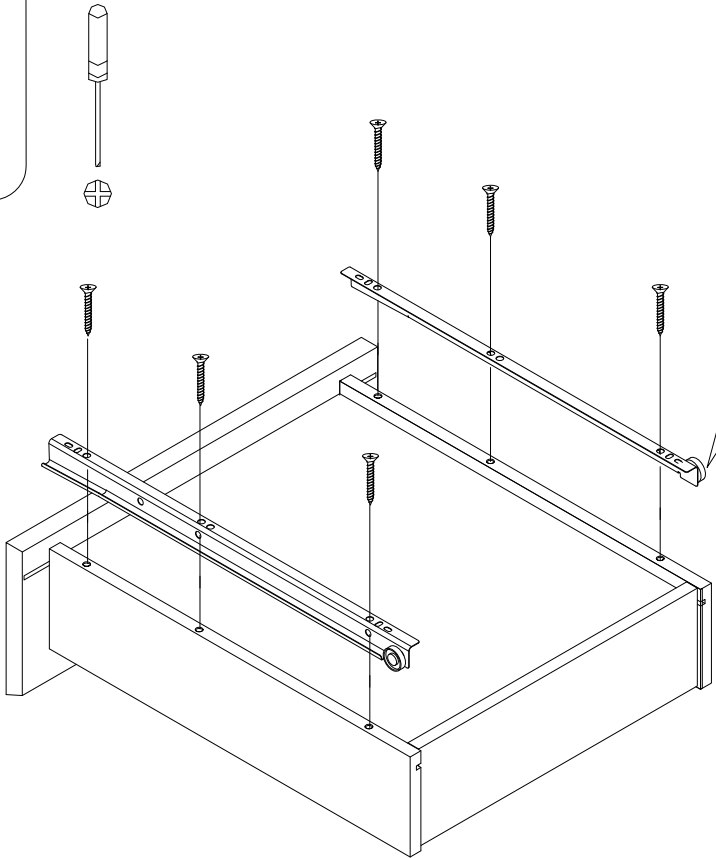
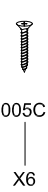
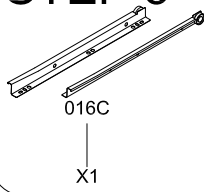

STEP 6

Will require these parts:

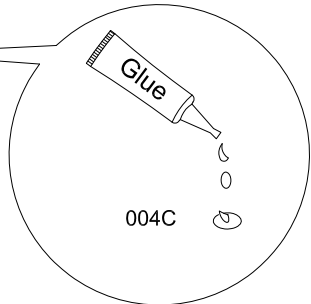
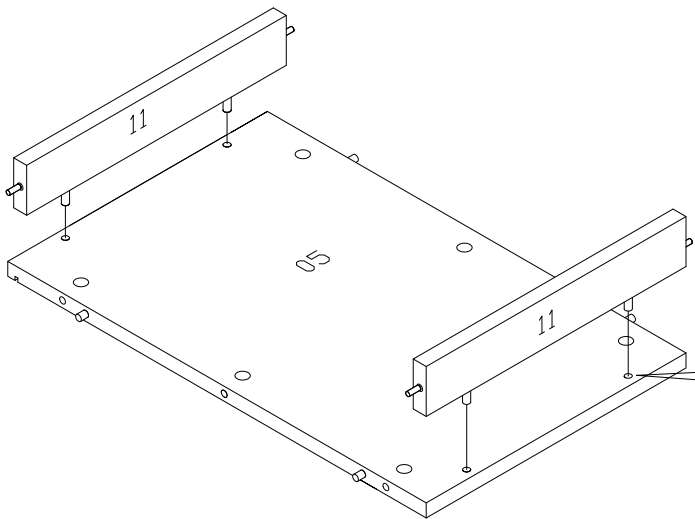

STEP 7

Will require these parts:



002C

X3

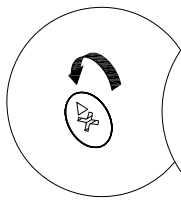
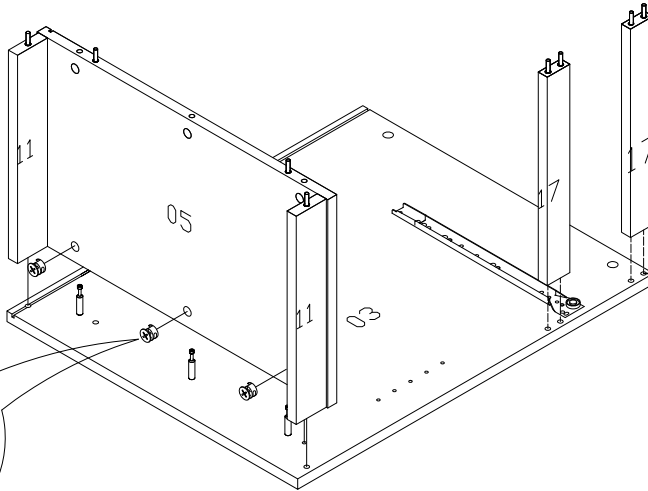

004C

002C
X 3

Arrow to point
in the direction
of end hole

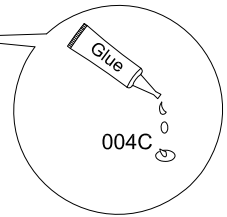

004C

STEP 8

Will require these parts:



002C

X3

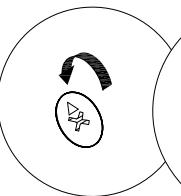
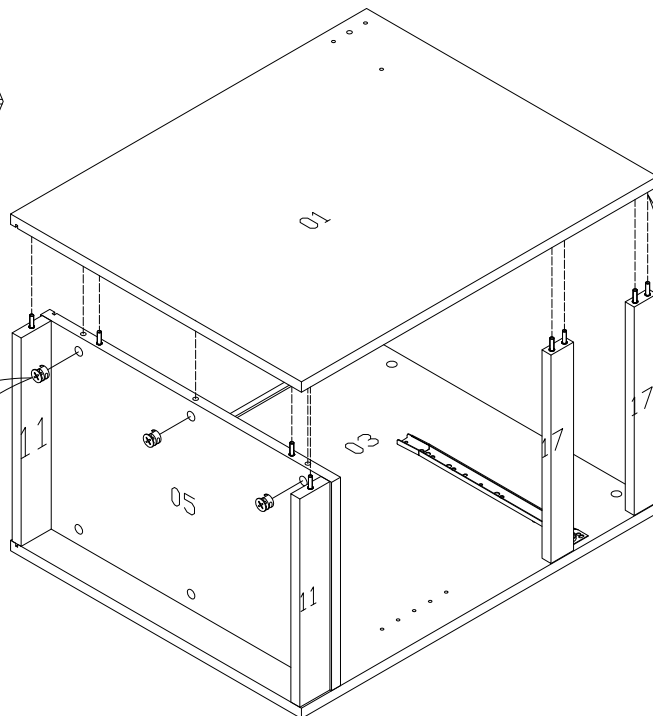

004C

002C
X 3

Arrow to point
in the direction
of end hole



004C

STEP 9

Will require these parts:

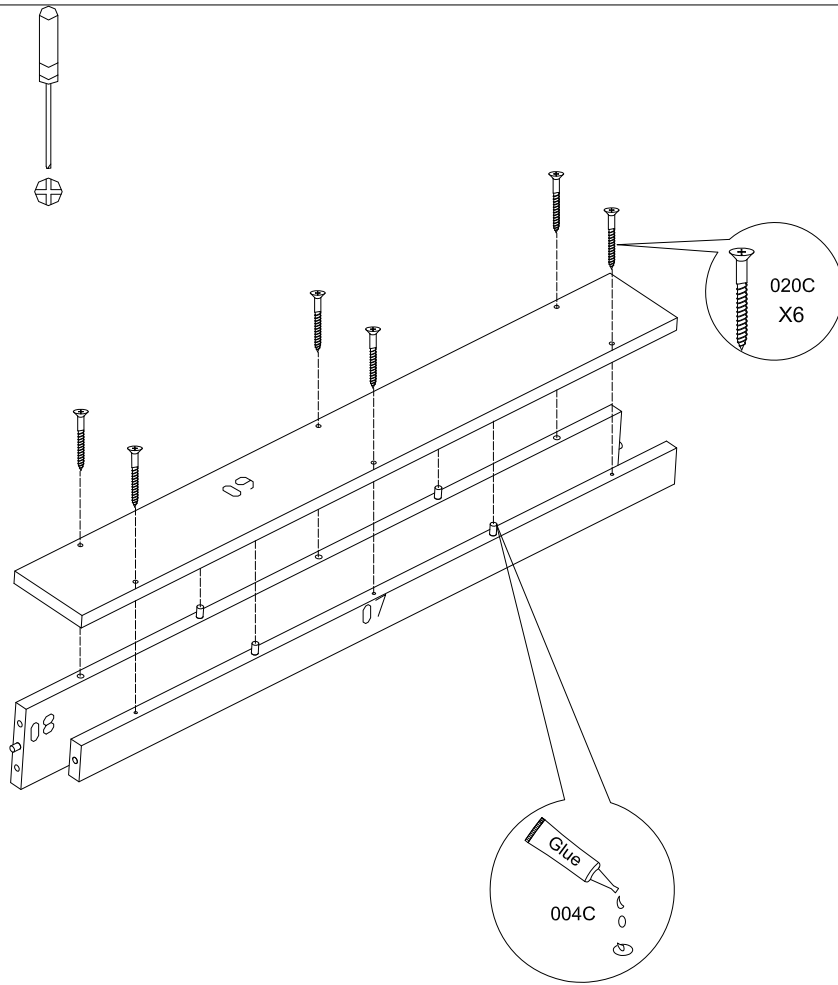

 020C
 X 6



 004C
**STEP 10**

Will require these parts:

 018C

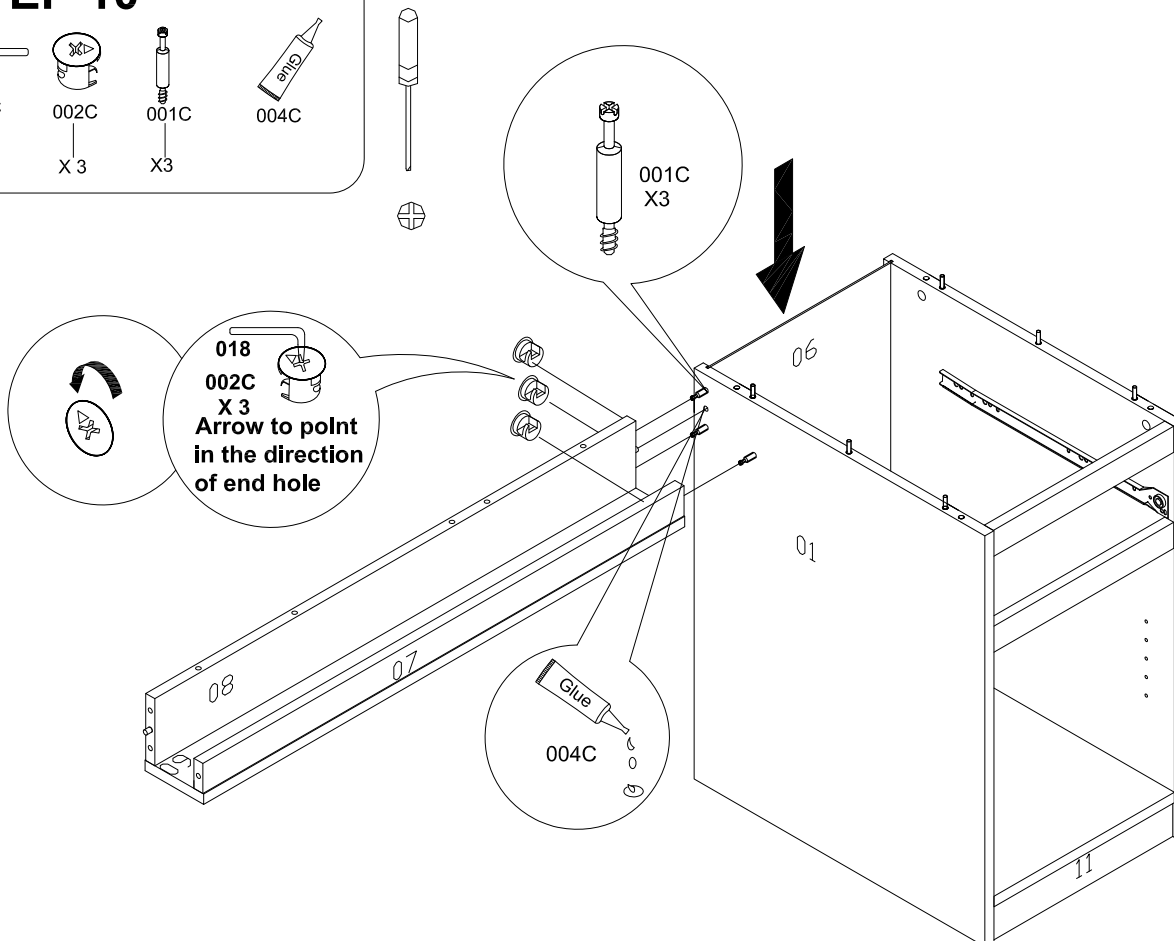

 002C
 X 3

 001C
 X 3

 004C

STEP 11

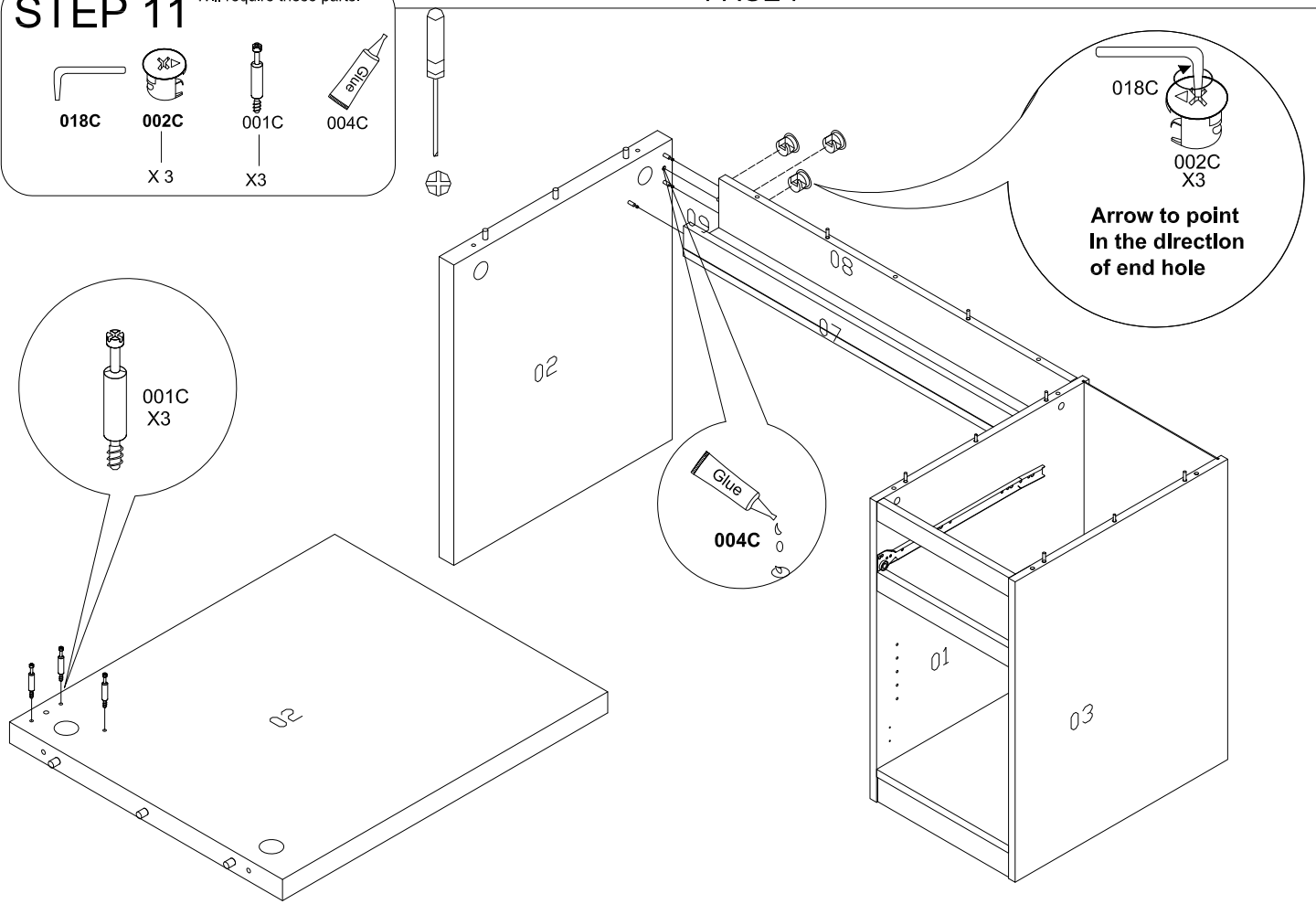
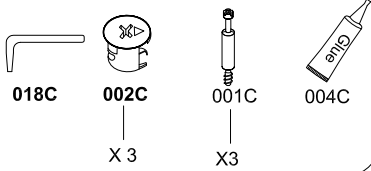
Will require these parts:





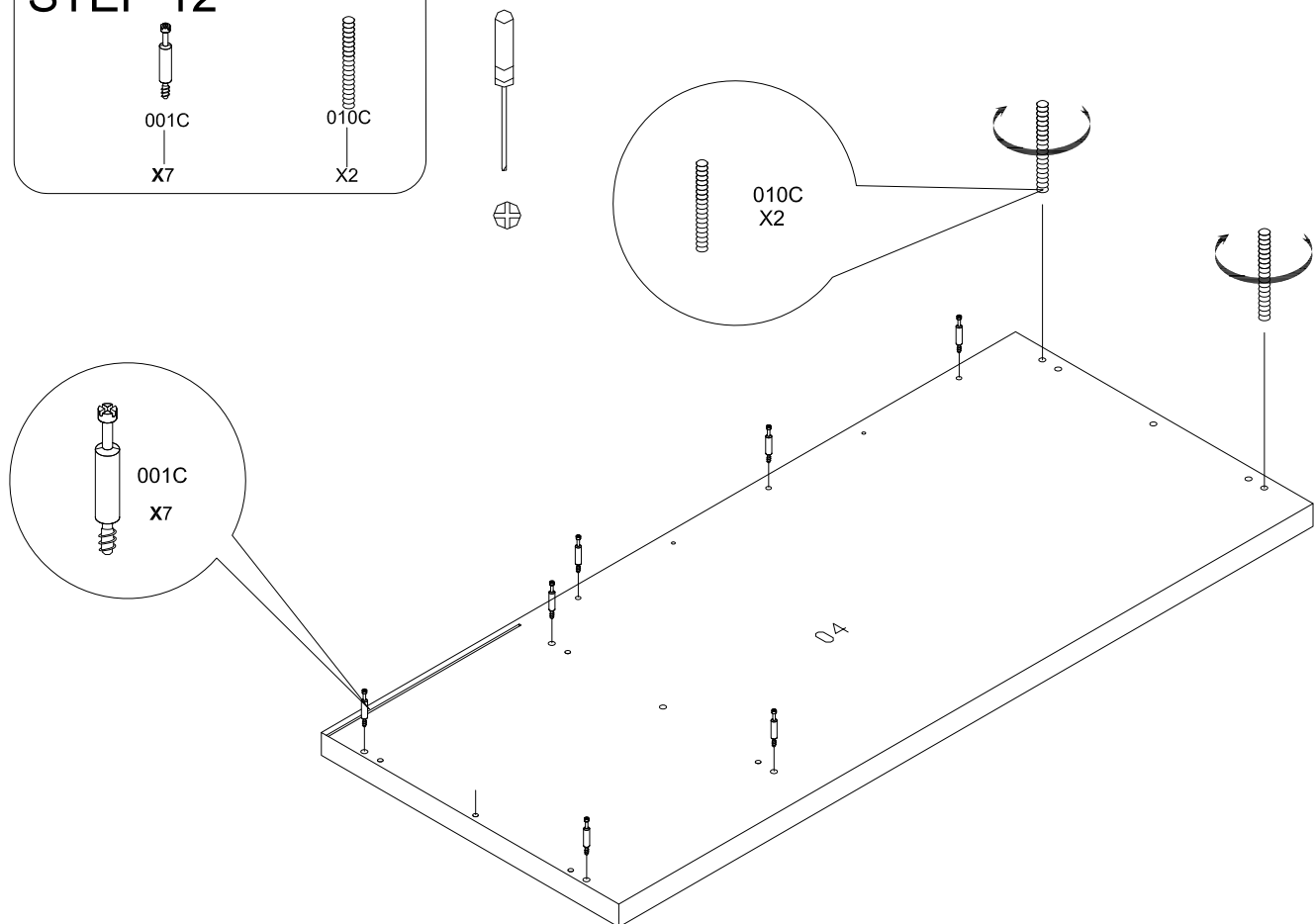
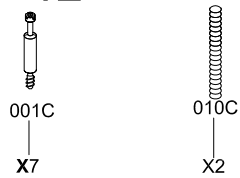

STEP 12

Will require these parts:

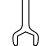

STEP 13

Will require these parts:

- | | | | | | |
|--|---|---|---|---|---|
|  |  |  |  |  |  |
| 002C | 011C | 012C | 013C | 004C | 019C |
| X7 | X2 | X2 | X1 | | X2 |

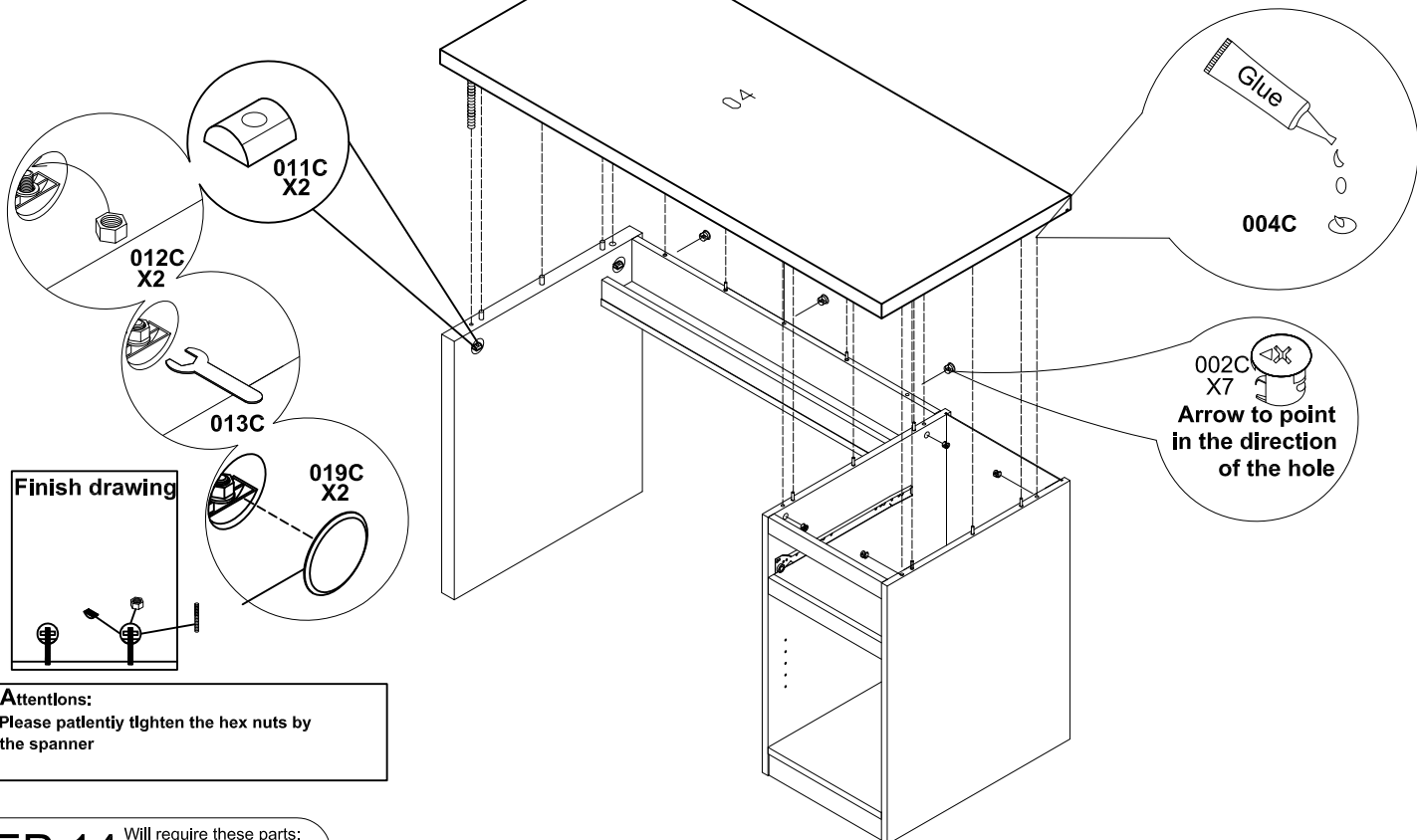

Attentions:
Please patiently tighten the hex nuts by the spanner

STEP 14

Will require these parts:

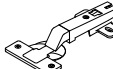
- | | |
|---|---|
|  |  |
| 006C | 017C |
| X 4 | X 2 |

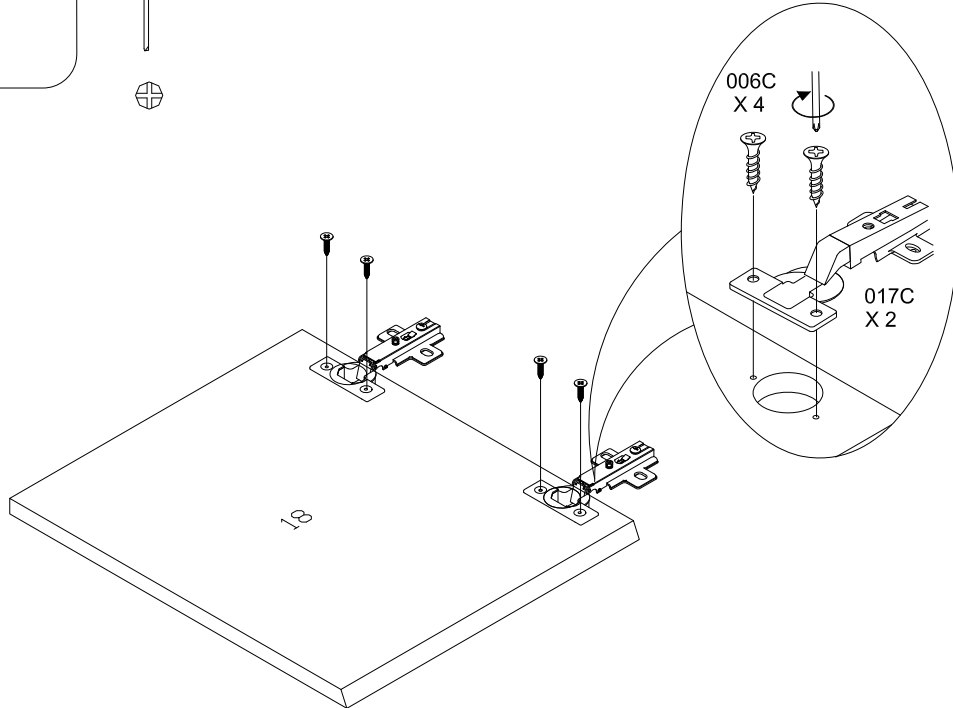

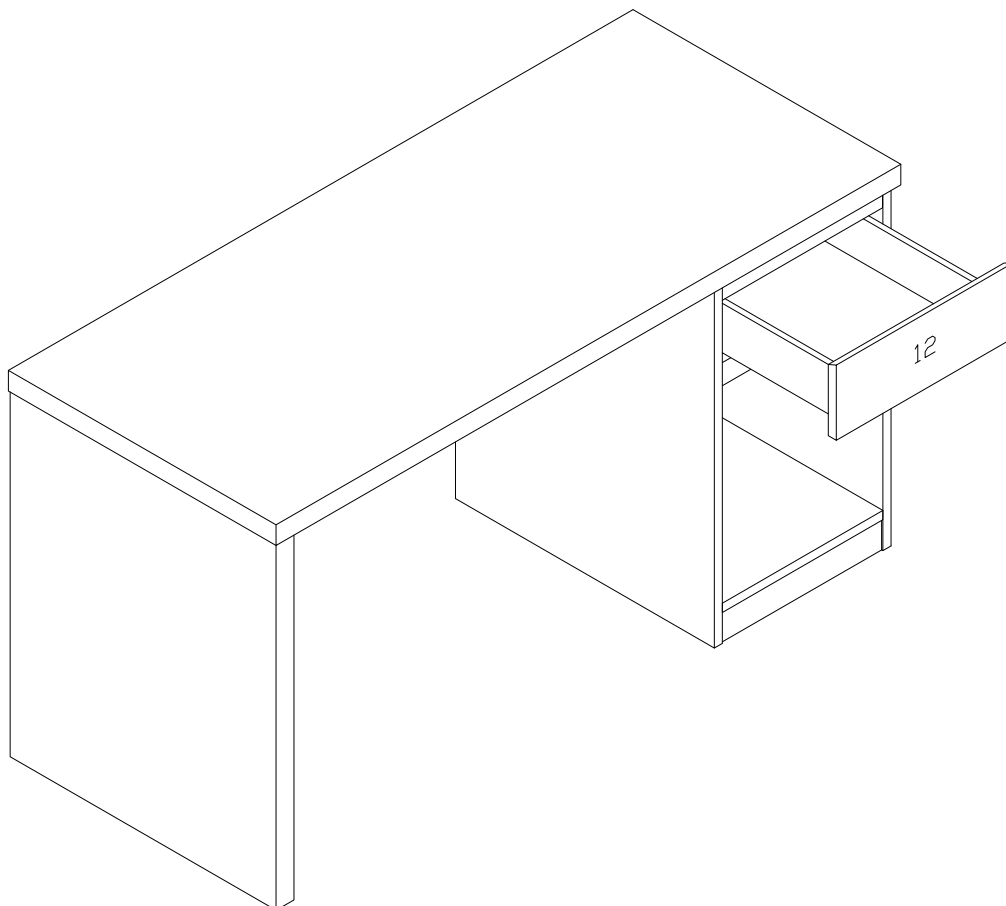
**STEP 16** Will require these parts:

008C

X 4



006C

X 4



009C

X 4

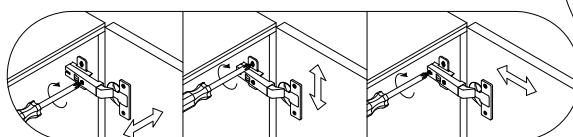
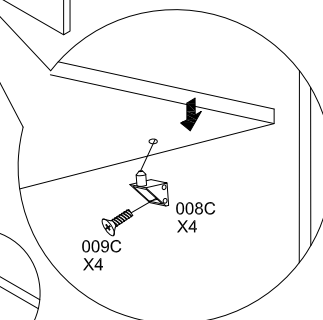
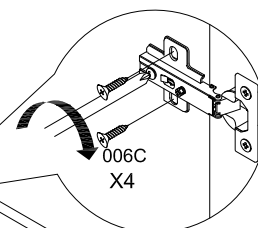
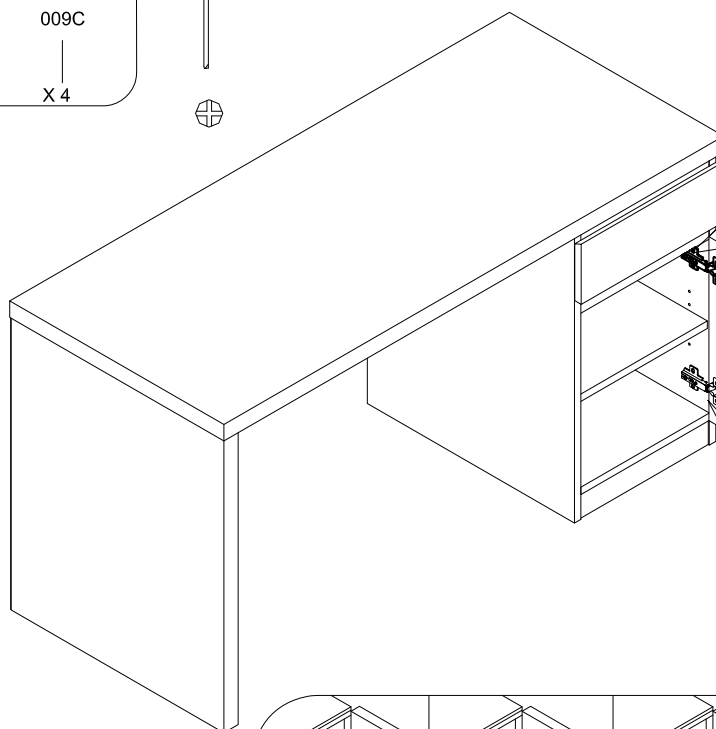
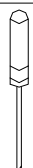

The job is now complete!

In the interest of our environment
please dispose of all packaging thoughtfully.